

FLOOR PLANS & CAPACITY CHARTS

WELCOME TO
MYSTIC LAKE
CENTER



MYSTIC LAKE
CENTER



MEETING SPACE
OVERVIEW

TOTAL HOTEL ROOMS 766
 TOTAL MEETING ROOMS 30
 LARGEST MEETING ROOM SIZE 17,327 SQ. FT.
 LARGEST MEETING ROOM CAPACITY 2,177

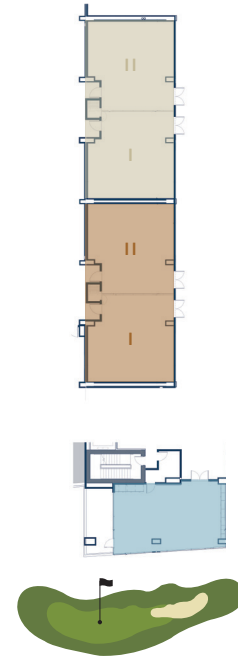
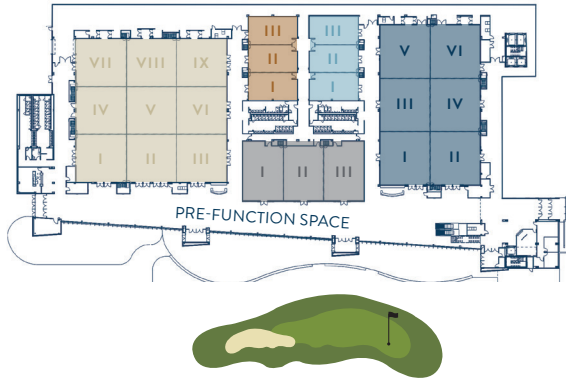

LEVEL 1

ROOM SPECS

SQ. FT. DIMENSIONS CEILING

MINNETONKA BALLROOM

17,327 128' X 135' 22'

WACONIA BALLROOM

12,737 143' X 89' 19'

ISANTI MEETING ROOMS

5,313 109' X 52' 15'

OWATONNA MEETING ROOMS

3,030 75' X 43' 12'

ANOKA MEETING ROOMS

3,030 75' X 43' 12'

PRE-FUNCTION SPACE

16,116 207' X 466' 22'

PATIO

13,800

LEVEL 3

ROOM SPECS

SQ. FT. DIMENSIONS CEILING

CHASKA MEETING ROOMS

1,688 61' X 30' 10'

WINONA MEETING ROOMS

1,694 61' X 30' 10'

SHAKOPEE BOARDROOM

884 38' X 23' 11'

LEVEL 1 - PART 1

MINNETONKA BALLROOM & PRE-FUNCTION SPACE

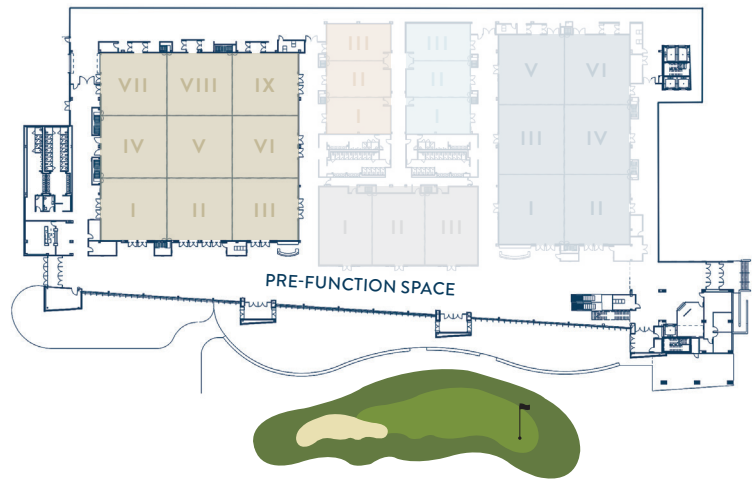

ROOM NAME	SQUARE FEET	DIMENSIONS	CEILING	THEATER	CLASSROOM	BANQUET	CONFERENCE
PRE-FUNCTION SPACE	16,116	207' x 466'	22'				
MINNETONKA BALLROOM							
TOTAL	17,327	128' x 135'	22'	2,177	1,288	1,080	0
MINNETONKA I	1,920	43' x 45'	22'	198	112	108	0
MINNETONKA II	1,936	43' x 45'	22'	198	112	108	0
MINNETONKA III	1,915	43' x 45'	22'	198	112	108	0
MINNETONKA IV	1,900	42' x 45'	22'	198	112	108	0
MINNETONKA V	1,879	42' x 45'	22'	198	112	108	0
MINNETONKA VI	1,883	42' x 45'	22'	198	112	108	0
MINNETONKA VII	1,893	42' x 45'	22'	198	112	108	0
MINNETONKA VIII	1,887	42' x 45'	22'	198	112	108	0
MINNETONKA IX	1,890	42' x 45'	22'	198	112	108	0

Capacities vary based on staging, display tables, audio visual equipment and other items requested to be placed in the room.

LEVEL 1 - PART 2

ANOKA AND OWATONNA MEETING ROOMS AND PATIO

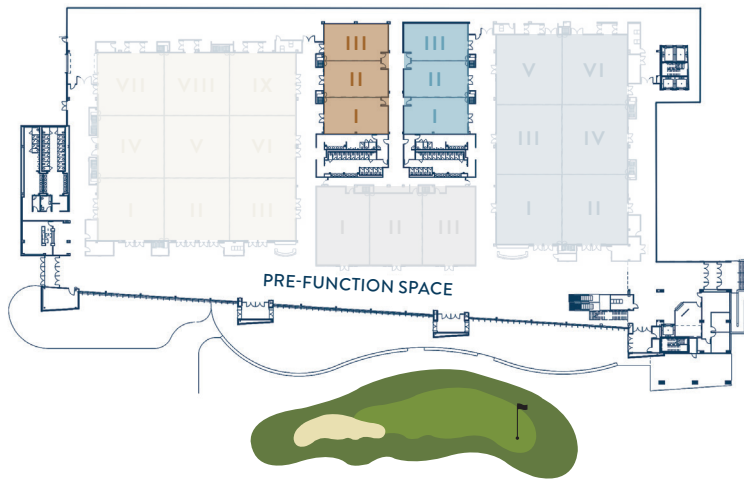

MYSTIC LAKE CENTER PATIO

ROOM NAME	SQUARE FEET	DIMENSIONS	CEILING	THEATER	CLASSROOM	BANQUET	CONFERENCE
PATIO	13,800						
OWATONNA MEETING ROOMS							
TOTAL	3,030	75' x 43'	12'	342	170	180	56
OWATONNA I	1,005	25' x 43'	12'	90	48	60	32
OWATONNA II	993	25' x 43'	12'	90	48	60	32
OWATONNA III	1,000	25' x 43'	12'	90	48	60	32
ANOKA MEETING ROOMS							
TOTAL	3,030	75' x 43'	12'	342	170	180	56
ANOKA I	1,005	25' x 43'	12'	90	48	60	32
ANOKA II	993	25' x 43'	12'	90	48	60	32
ANOKA III	1,000	25' x 43'	12'	90	48	60	32

LEVEL 1 - PART 3

ISANTI AND WACONIA BALLROOMS

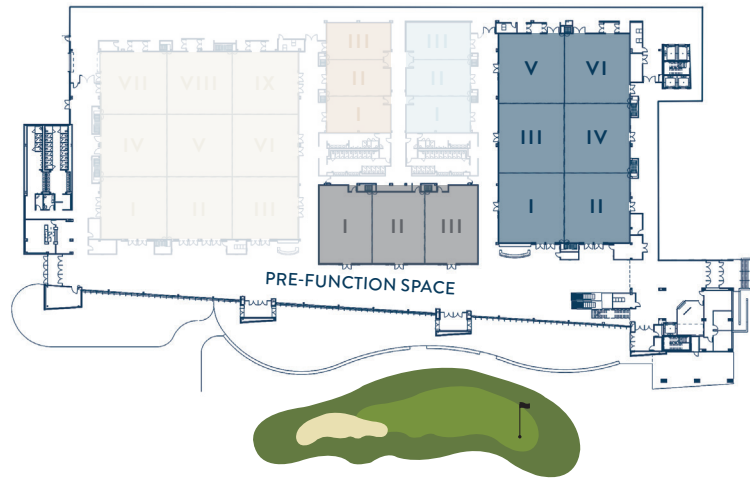

ROOM NAME	SQUARE FEET	DIMENSIONS	CEILING	THEATER	CLASSROOM	BANQUET	CONFERENCE
ISANTI BALLROOM							
TOTAL	5,313	109' x 52'	15'	624	346	320	96
ISANTI I	1,790	52' x 36'	15'	168	80	90	40
ISANTI II	1,687	47' x 36'	15'	168	80	90	40
ISANTI III	1,799	52' x 36'	15'	168	80	90	40
WACONIA BALLROOM							
TOTAL	12,737	143' x 89'	19'	1,728	760	770	0
WACONIA I	2,099	47' x 44'	19'	240	120	90	44
WACONIA II	2,120	47' x 45'	19'	240	120	90	44
WACONIA III	2,085	47' x 44'	19'	240	120	90	44
WACONIA IV	2,106	47' x 45'	19'	240	120	90	44
WACONIA V	2,090	48' x 44'	19'	240	120	90	44
WACONIA VI	2,110	48' x 45'	19'	240	120	90	44

LEVEL 3

CHASKA AND WINONA MEETING ROOMS AND SHAKOPEE BOARDROOM

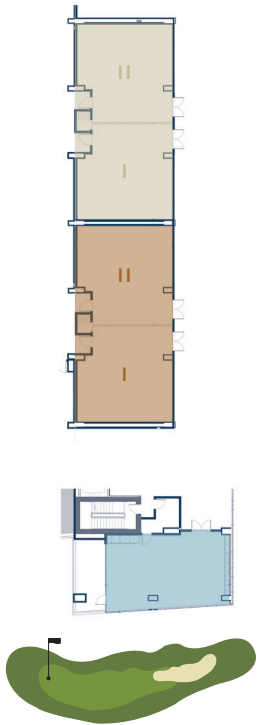

SHAKOPEE BOARDROOM

ROOM NAME	SQUARE FEET	DIMENSIONS	CEILING	THEATER	CLASSROOM	BANQUET	CONFERENCE
CHASKA MEETING ROOMS							
TOTAL	1,688	61' x 30'	10'	168	88	100	48
CHASKA I	829	30' x 30'	10'	66	40	40	24
CHASKA II	848	31' x 30'	10'	66	40	40	24
WINONA MEETING ROOMS							
TOTAL	1,694	61' x 30'	10'	168	88	100	48
WINONA I	830	31' x 30'	10'	66	40	40	24
WINONA II	854	30' x 30'	10'	66	40	40	24
SHAKOPEE BOARDROOM							
TOTAL	884	38' x 23'	11'	0	0	0	22



2400 Mystic Lake Blvd.
Prior Lake, MN, 55372



mysticlakecenter.com



sales@mysticlake.com
1-866-832-6402

OWNED & OPERATED BY THE SHAKOPEE
MDEWAKANTON SIOUX COMMUNITY

Mystic Lake®, Mystic Lake Casino Hotel®, Mystic Lake Center®, Little Six Casino®, Little Six®, Club M® and Mystic Showroom® are registered trademarks of the Shakopee Mdewakanton Sioux Community.



MYSTIC LAKE
CENTER