



MYSTIC LAKE
CENTER

MYSTIC LAKE CENTER® JOINS MYSTIC LAKE® TO FORM
THE ONLY FULL-SERVICE RESORT IN THE TWIN CITIES.
SHOWCASING A MODERN, UPSCALE DESIGN, MYSTIC LAKE
CENTER ACCOMMODATES GROUPS OF ANY SIZE.

VENUE HIGHLIGHTS



130,000 square feet of dedicated meeting and event space

180-room hotel tower joins *Mystic Lake* for a total of 766 renovated, modern hotel rooms

Built-in lighting, AV systems, HD video screens and experienced on-site AV teams

Complimentary valet parking for hotel guests and designated parking for meeting guests

Award-winning culinary team, exciting catering options and unique packages and displays

MEETING SPACE OVERVIEW

TOTAL HOTEL ROOMS	766
TOTAL MEETING ROOMS	30
LARGEST MEETING ROOM SIZE	17,327 SQ. FT.
LARGEST MEETING ROOM CAPACITY	2,177

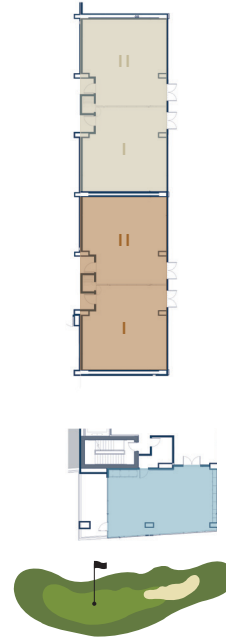
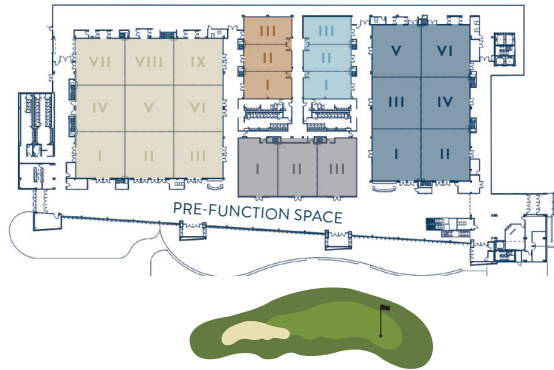

LEVEL 1

ROOM SPECS

SQ. FT.	DIMENSIONS	CEILING
---------	------------	---------

MINNETONKA BALLROOM

17,327	128' X 135'	22'
--------	-------------	-----

WACONIA BALLROOM

12,737	143' X 89'	19'
--------	------------	-----

ISANTI MEETING ROOMS

5,313	109' X 52'	15'
-------	------------	-----

OWATONNA MEETING ROOMS

3,030	75' X 43'	12'
-------	-----------	-----

ANOKA MEETING ROOMS

3,030	75' X 43'	12'
-------	-----------	-----

PRE-FUNCTION SPACE

16,116	207' X 466'	22'
--------	-------------	-----

PATIO

13,800

LEVEL 3

ROOM SPECS

SQ. FT.	DIMENSIONS	CEILING
---------	------------	---------

CHASKA MEETING ROOMS

1,688	61' X 30'	10'
-------	-----------	-----

WINONA MEETING ROOMS

1,694	61' X 30'	10'
-------	-----------	-----

SHAKOPEE BOARDROOM

884	38' X 23'	11'
-----	-----------	-----

LEVEL 1 - PART 1

MINNETONKA BALLROOM & PRE-FUNCTION SPACE

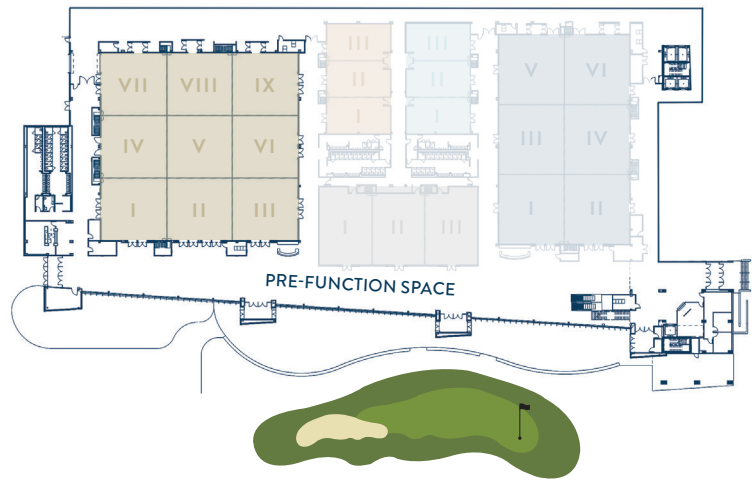

ROOM NAME	SQUARE FEET	DIMENSIONS	CEILING	THEATER	CLASSROOM	BANQUET	CONFERENCE
PRE-FUNCTION SPACE	16,116	207' x 466'	22'				
MINNETONKA BALLROOM							
TOTAL	17,327	128' x 135'	22'	2,177	1,288	1,080	0
MINNETONKA I	1,920	43' x 45'	22'	198	112	108	0
MINNETONKA II	1,936	43' x 45'	22'	198	112	108	0
MINNETONKA III	1,915	43' x 45'	22'	198	112	108	0
MINNETONKA IV	1,900	42' x 45'	22'	198	112	108	0
MINNETONKA V	1,879	42' x 45'	22'	198	112	108	0
MINNETONKA VI	1,883	42' x 45'	22'	198	112	108	0
MINNETONKA VII	1,893	42' x 45'	22'	198	112	108	0
MINNETONKA VIII	1,887	42' x 45'	22'	198	112	108	0
MINNETONKA IX	1,890	42' x 45'	22'	198	112	108	0

Capacities vary based on staging, display tables, audio visual equipment and other items requested to be placed in the room.

LEVEL 1 - PART 3

ISANTI AND WACONIA BALLROOMS

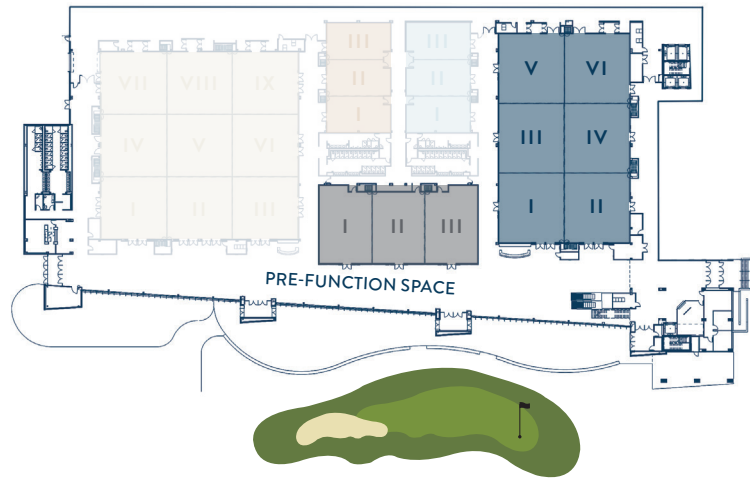

ROOM NAME	SQUARE FEET	DIMENSIONS	CEILING	THEATER	CLASSROOM	BANQUET	CONFERENCE
ISANTI BALLROOM							
TOTAL	5,313	109' x 52'	15'	624	346	320	96
ISANTI I	1,790	52' x 36'	15'	168	80	90	40
ISANTI II	1,687	47' x 36'	15'	168	80	90	40
ISANTI III	1,799	52' x 36'	15'	168	80	90	40
WACONIA BALLROOM							
TOTAL	12,737	143' x 89'	19'	1,728	760	770	0
WACONIA I	2,099	47' x 44'	19'	240	120	90	44
WACONIA II	2,120	47' x 45'	19'	240	120	90	44
WACONIA III	2,085	47' x 44'	19'	240	120	90	44
WACONIA IV	2,106	47' x 45'	19'	240	120	90	44
WACONIA V	2,090	48' x 44'	19'	240	120	90	44
WACONIA VI	2,110	48' x 45'	19'	240	120	90	44



WELCOME TO
MYSTIC LAKE
CENTER



HERE, INNOVATION IS A

NATURAL ELEMENT

Inspired by the beautiful scenery and changing seasons of Minnesota, Mystic Lake Center combines the elements of nature with modern, functional design and state-of-the-art technology, innovation and quality.

More than a meeting space, Mystic Lake Center builds a true connection between work, socializing and nature. With distinguishing features and exceptional design, Mystic Lake Center showcases:

DYNAMIC SAGEGLASS® 11,000 square feet of glasswork provides natural light and electro-chromic technology that reacts to sunlight, preventing glare and heat gain

CUSTOM CHANDELIERS An intricate design emulates drops of rainwater on a lake

WOOD PORTALS Representing the curve of a cattail, oversized wood portals welcome guests and lead into versatile ballrooms

ILLUMINATED ART Wall décor and lighting reflects the colors of the seasons

MODERN FINISHES Textured patterned carpet in blue and gray tones depict the movement of a flowing river





A WELL-APPOINTED RETREAT

AT THE END OF THE DAY

With the addition of 180 hotel rooms in a stunning nine-story tower, Mystic Lake Center joins Mystic Lake Casino Hotel® to form one of the largest hotels in the Twin Cities metro area, with a total of 766 rooms.

HOTEL ROOMS AND LUXURY SUITES INCLUDE:

- Golf course views
- Refrigerators
- Coffee makers
- Complimentary high-speed Wi-Fi
- 49" HDTVs and enhanced television channels
- Indoor pool and hot tub
- Vestibule entrance, residential layout and comfortable sun bay seating area





A BUSINESS ENVIRONMENT

WITH ATMOSPHERE

SHAKOPEE BOARDROOM

Showcasing unbeatable views of The Meadows at Mystic Lake golf course, the Shakopee Boardroom offers a beautiful and versatile space to conduct business, meetings and private parties.

- Houses 884 square feet of meeting space with room for 22 guests, conference-style
- 38' x 23' with 11' ceilings
- Floor to ceiling SageGlass® provides natural light and gorgeous golf course views
- Private adjoining balcony provides additional meeting space overlooking the golf course
- Worry-free video presentation systems compatible with QuickTime, Keynote and PowerPoint





MYSTIC LAKE
CENTER

MYSTIC LAKE
CENTER

NATURALLY

CONNECTED

WACONIA BALLROOM

The perfect space to conduct business and host memorable events, the Waconia Ballroom offers six spacious rooms, easily divided, allowing a smooth flow and easy guest access to the main center entrance.

- 12,737 square feet of open, flexible space
- Accommodates groups up to 1,728, theater-style
- 143' x 89' with 19' ceilings
- Intricate, modern ceiling design showcases movement of a flowing river
- Advanced technological capabilities with built-in lighting and AV systems
- Conveniently located by the Grand Entry with designated space for on-site branding opportunities





NATURALLY

ENTERTAINING

MINNETONKA BALLROOM

One of the largest ballrooms in the Twin Cities, the Minnetonka Ballroom accommodates groups of any size—industry conventions, conferences, high-profile galas, holiday parties and wedding receptions.

- 17,327 square feet of open, functional space
- 128' x 135'
- Accommodates groups up to 2,177, theater-style
- Expansive 22' ceilings and custom wood portals at every entry
- Custom Z-track system allows for hanging banners, marketing materials and décor
- Dedicated loading area allows straight access into ballroom
- Built-in lighting and AV systems with HD projection and video screens offer engaging multimedia experience
- Conveniently located by the kitchen, allowing quick access and ease of service





WHERE WORK AND PLAY LIVE IN

PERFECT HARMONY

Mystic Lake Center offers a beautiful, versatile space to host memorable meetings and events just steps away from restaurants, bars and nonstop entertainment.

UNIQUE DINING Distinct bars and restaurants offer something for every taste and budget. Private dining experiences and custom menus are available per request by group size.

LIVELY CASINO Play slots, blackjack, bingo and pulltabs at one of the largest casinos in the Midwest. Group gaming packages also available.

EXCITING ENTERTAINMENT 2,100-seat Mystic Showroom® features concerts, shows and national entertainment.

THE MEADOWS AT MYSTIC LAKE 18-hole championship golf course offers a unique, challenging and scenic experience.

THE SPA AT MYSTIC LAKE® On-site spa offers relaxing massages, facials and rejuvenating treatments.



ECONOMIC IMPACT & ENTERPRISES

The Shakopee Mdewakanton Sioux Community (SMSC) owns and operates a diverse collection of enterprises on its land in Prior Lake and Shakopee, Minnesota. From a tribal garden and two convenience stores to Mystic Lake Casino Hotel and Mystic Lake Center, the enterprises help drive the local economy.

DAKOTAH! SPORT AND FITNESS A full-service, family friendly health and wellness center

LITTLE SIX CASINO® A short shuttle ride from Mystic Lake, Little Six offers an intimate gaming experience, bar and restaurant

WOZUPI TRIBAL GARDENS An organic farm that nourishes the community

SMSC WATER BOTTLING State-of-the-art plant delivers and donates bottled water

SMSC ORGANICS RECYCLING FACILITY Transforming yard waste into nutrient-rich compost

MDEWAKANTON PUBLIC SAFETY Providing on-site emergency services and education

PLAYWORKS Featuring a large indoor play area and child care

AND MORE... The Meadows at Mystic Lake, Dakotah Mini Storage, Dakotah Meadows RV Park, Playworks LINK Event Center and Shakopee Dakota Convenience Stores

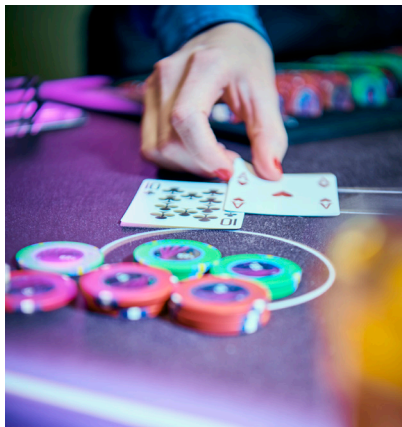

GREEN

INITIATIVES

As a steward of the land, the SMSC engages in a number of activities to preserve and protect the environment for future generations. When you choose to host your meeting or event at Mystic Lake Center, you can be confident you're making an environmentally friendly decision.

INITIATIVES IMPLEMENTED AROUND THE PROPERTY:

- Produce from the SMSC organic garden is used seasonally on banquet menus
- All restaurants with table service use non-disposable serving ware, excluding takeout orders
- Irrigation of the golf course is provided via the SMSC Water Reclamation Facility
- Cleaning supplies used by housekeeping are non-phosphorus products
- Paper, aluminum cans, plastic bottles and batteries are all recycled
- The SMSC Water Reclamation Facility features a green roof and treats wastewater from the casino and area tribal businesses
- Recycling bins property-wide

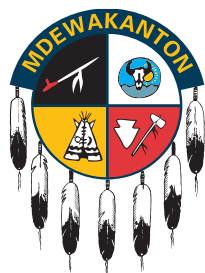

SMSC GAMING
ENTERPRISE



usbank
stadium

DOWNLOAD THE VIKINGS APP
DOWNLOAD THE VIKINGS APP AT THE
APP STORE OR ON GOOGLE PLAY

DO NOT ENTER ENTER

WELCOME VIKINGS FANS

947

A CONVENIENT

LOCATION

Located just 25 miles southwest of Minneapolis and Saint Paul, Mystic Lake Center is conveniently located by unique attractions, world class festivals and breathtaking scenery. Plus, enjoy complimentary shuttle service at more than 50 stops throughout Minnesota on the Mystic Shuttle and Mystic Express to Mall of America®.

MALL OF AMERICA From musical acts and celebrity book signings to an extensive range of retail, restaurants and entertainment, Mall of America is a must-stop tour destination.

U.S. BANK STADIUM Catch a football game in Mystic Lake's Club Purple or book your stay at Mystic Lake and enjoy free shuttle rides downtown during home games.

CANTERBURY PARK Located five miles from Mystic Lake, enjoy live outdoor Thoroughbred and Quarter Horse racing from mid-May through mid-September.

VALLEYFAIR Enjoy the area's premier seasonal waterpark, more than 75 rides and attractions, and entertainment just six miles from Mystic Lake.

MINNESOTA RENAISSANCE FESTIVAL Visit an authentic 16th century village with artisan booths, endless shopping, live armored jousting and more August through October.

MSP INTERNATIONAL AIRPORT Servicing a variety of commercial passenger airlines, MSP is conveniently located 25 minutes north of Mystic Lake.





MYSTIC LAKE
CENTER

BRING YOUR BRAND TO LIFE

CREATE A UNIQUE, IMMERSIVE EXPERIENCE FOR YOUR NEXT EVENT WITH A CUSTOM BRANDING PACKAGE! OUR ON-SITE SIGN SHOP PROVIDES UNPARALLELED CUSTOMIZATION OPTIONS, OVERSEEING EXPERT PRINTING AND INSTALLATION DOWN TO THE LAST DETAIL. OUR MEETING AND EVENT PROFESSIONALS WORK COLLABORATIVELY WITH OUR IN-HOUSE MARKETING TEAM TO ENSURE EVERY ASPECT OF YOUR EVENT LEAVES A LASTING IMPRESSION.

PRINT COLLATERAL



FLOOR DECAL

SPECS

2' x 3'
6' x 6'

PRICE

\$50 each
\$200 each



FLOOR BOARD

CANNOT KEEP BASE

SPECS

Double Sided
24" x 60" - 80"

PRICE

\$100 each



THREE COLUMN
PILLAR - LARGE

SPECS

(3) 4' x 8' Panels

PRICE

\$500 each



ESCALATOR GLASS
PANEL WRAPS

SPECS PRICE

23' x 23.5' \$500 each

3 Total Panels Available,
6 Panels for Double Sided



HORIZONTAL CEILING
BANNER

SPECS PRICE

Double Sided \$150 each
8' x 3'



VERTICAL CEILING
BANNER

SPECS

Double Sided
3' x 8'

PRICE

\$150 each



**THREE COLUMN
PILLAR - SMALL**

SPECS
(3) 16" x 96" Panels

PRICE
\$250 each



**GLASS PANEL WRAPS
OVERLOOKING PRE-FUNCTION**

SPECS **PRICE**
Double Sided \$200 each
46.625" x 35.125"
for each image
5 Total Panels Available



LOLLIPOP SIGNS

CANNOT KEEP STICK AND FRAME

SPECS **PRICE**
Double Sided \$150 each
32" Circle



**HANGING BANNER
ABOVE NORTH ENTRANCE**

SPECS **PRICE**
17' x 8'
Max 1 \$900 each



**HANGING BANNER
ACROSS FROM ISANTI**

SPECS **PRICE**
12' x 10'
Max 2 \$800 each

DESIGN SERVICES

\$150/hour

INSTALLATION FEE

Applies if printing your own collateral and utilizing the Mystic Lake® team for install

Available Mon – Fri

7 am – 3:30 pm

\$150/hour

PRINT COLLATERAL



WATERFALL STONE
TABLE - FULL WRAP

SPECS

48.5" x 188.25"

Overall Wrap

Legs/Side Only:

48.5" x 33.75"

Table Top Only:

48.5" x 120.75"

4 Tables Available

PRICE

\$350 each

\$250 each

\$250 each



POSTER

SPECS

22" x 28"

24" x 36"

Easel Included

PRICE

\$50 each

\$50 each



POSTER IN SILVER
STANDS

SPECS

22" x 28"

PRICE

\$50 each



BAR WRAPS

PRICE

\$100 each



ICE CREAM COOLER
WRAP

PRICE

\$250 each



PHONE CHARGING
STATION

PRICE

\$250 each

Includes phone charging station rental and custom branded wrap.

3 or more ordered price goes up to \$350 each.



SANDWICH BOARD
OUTDOOR ONLY

SPECS
Double Sided
24" x 36"

PRICE
\$75 each



WELCOME DESK BANNER

SPECS
169" x 35.5"
Minnetonka
255" x 35.5"
Waconia

PRICE
\$250 each
\$350 each



STEP & REPEAT BACKDROP

SPECS
8' x 8'

PRICE
\$450 each



12 OZ. WATER BOTTLES

PRICE
16 oz bottles for \$4 each
Includes custom branded label and bottle
Five case minimum

\$3 each



TABLE TENT

SPECS
4" x 6"
5" x 7"
8.5" x 11"

PRICE
\$3 each
\$5 each
\$7 each

DESIGN SERVICES

\$150/hour

INSTALLATION FEE

Applies if printing your own collateral and utilizing the Mystic Lake® team for install

Available Mon – Fri

7 am – 3:30 pm

\$150/hour

DIGITAL SIGNAGE

All digital signage is priced per day/per AV player.
Please work with your sales executive to schedule content.



NINE-PANEL VIDEO -
STATIC

SPECS
1920px x 1080px
Static Files – 72 dpi
File Types: .jpg or .png

PRICE
\$300/day



NINE-PANEL VIDEO -
ANIMATED

SPECS
1920px x 1080px
30fps, H.264/15 Mbps
File Type: .mp4

PRICE
\$350/day



BALLROOM
ENTRANCE TVs

SPECS
1080px x 1920px
72 dpi

PRICE
\$50 per screen
per day



KIOSK TVs
NORTH ENTRANCE BY THE
ESCALATORS

SPECS
1080px x 1920px

PRICE
\$200 per TV
per day



WELCOME DESK TVs
BY MINNETONKA OR WACONIA

SPECS
1080px x 1920px

PRICE
\$200 per TV
per day

FILE REQUIREMENTS

Print Collateral

File Type: Please provide actual size jpg at 150 dpi or half-size at 300 dpi, or scalable vector file with outlined fonts and all placed images embedded. Please send all final print files to your sales executive via WeTransfer, Dropbox or the file sharing hosting site of your choice.

Print collateral is priced per piece and includes printing and installation. Client is responsible for all placement and removal of all outside signage. Specs below are listed 'width x height' format. All artwork files are required 4 weeks prior to event date. **Rush pricing may apply for files sent after original deadline. Please work with your sales executive to confirm quantity and installation schedules.**

Digital Collateral

Video/Animated Files: 30 fps, H.264/15 Mbps
File Type: .mp4

Static Files: 72 dpi
File Types: .jpg or .png





MYSTIC LAKE
CENTER

AUDIO VISUAL

& OTHER SERVICES | OPTIONS AND PRICING

AUDIO

MICROPHONES

Shure Wireless Lavalier/Handheld/Headset	\$115
Wired Handheld with Tabletop Stand	\$25

AUDIO ACCESSORIES

Computer Audio (D.I.) Box	\$20
Audio Feed XLR (Recording or Input)	\$25 per feed
Background Music	\$25
House Sound Audio Patch Input	\$50 per room

PA SYSTEMS

Two QSC Paired Powered Speakers and Two Subwoofers	\$470
Four QSC KLA Line Array Speakers Ground Stacked on Four 18" QSC Subs	\$1,050
Six Speaker Line Array with Four Subs	\$1,600
16 Channel Digital Mixer with Snake	\$250
32 Channel Digital Mixer with Snake	\$475

INTERCOM SYSTEMS

Wireless Intercom System (Up to 10 Headset Packs)	\$250
---	-------



VIDEO

VIDEO RECORDERS/PLAYERS

DVD Player	\$35
Session Recording (does not include camera)	\$250 per feed

MONITORS

40" LCD 16:9 w/stand	\$175
49" LCD 16:9 w/stand	\$300
65" LCD 16:9 w/stand	\$425
Truss Tower Video Display (Includes one truss tower and base, one 49" LCD display and mount, cabling and labor)	\$375

CAMCORDERS/CAMERAS

Sony® ENG Broadcast Camera	\$1,000
Panasonic® Robocam	\$1,000

DISPLAY SCREENS

9' x 16' Fastfold Screen w/dress kit (16:9)	\$300
7.5' x 11' Fastfold Screen (16:9) (no dress kit)	\$190
Video Wall(s)	Quote
Video Walls (Mystic Showroom)	\$2,550

VIDEO MISCELLANEOUS

Computer Adaptors	\$30
Perfect Cue	\$75
Computer Cable (VGA, HDMI etc.)	\$20
Presenter's Remote	\$55
AV Cart with Power Extension	\$25

PROJECTORS

7K Lumen HD Projector	\$600
12K Lumen HD Projector	\$1,050
20K Lumen HD Projector	Quote

VIDEO SWITCHERS/PROCESSORS

HDMI or VGA Splitter	\$30
Seamless Video Switcher (Digital)	\$425

LIGHTING

INDIVIDUAL FIXTURES

6" Source Four Par with Dimming Circuit (Used for stage wash, pin spotting and wall Gobos)	\$35
LED Par Light (ETC, Chavet)	\$25
LED Bar Light (Chavet)	\$40
Moving Head Fixtures (various)	\$95
Follow Spot with Operator	\$400

LIGHTING CONTROL

NX2 Digital Lighting Console	\$255
------------------------------	-------

LIGHTING DÉCOR

In-House Stock Gobos (textured wall lighting)	\$10/ea
Custom Gobo (steel or glass)	Quote
Mirror Ball	\$65
Aluminum Truss with Base (12")	\$65
Hazer with Fluid	\$130
18' x 50' Black or White Pipe & Drape	\$10/ft
Custom Backdrop	Quote
Color Gel (per sheet)	\$20

RIGGING

Rigging Point	\$105
Scissor Lift (Additional Labor Needed)	\$225
Haze Permit (Fire System Override)	\$250

STAGING

4' x 8' Stage Decking with Skirt	\$65/ea
4' x 8' Stage Decking with Skirt 32" high with Bracing	\$75/ea
Staging Steps (single)	\$15
Staging Steps (triple)	\$80
Showroom Steps	\$210

LIGHTING PACKAGES

ATMOSPHERIC LIGHTING PACKAGE | \$300

LED Pixbar up-lighting of a ballroom or meeting space

CORPORATE LIGHTING PACKAGE | \$650

Includes Atmospheric Lighting Package + 4 Stage Wash Leko lights, 2 Gobo Leko lights and NX2 lighting console

*CUSTOM GOBOS NOT INCLUDED

KEYNOTE LIGHTING PACKAGE | \$950

Includes Atmospheric Lighting Package + 4 Stage Wash Leko lights, 4 Gobo Leko lights, 8 Texture Leko lights and NX2 lighting console

*CUSTOM GOBOS NOT INCLUDED

GALA LIGHTING PACKAGE | \$1,660

Includes Atmospheric Lighting Package, 6 Stage Wash Leko lights, 6 Gobo Leko lights, 8 Moving-Head light fixtures and NX2 lighting console

*CUSTOM GOBOS NOT INCLUDED

SHOWROOM VIDEO IMAG PACKAGES

BASIC PACKAGE

\$3,800

Includes a single camera, computer interface and up to eight hours of labor or AV assistance.

Available in Showroom only

ADVANCED PACKAGE

\$4,850

Includes two broadcast cameras, two robo cameras, computer interface and up to eight hours of labor or AV assistance.

Available in Showroom only

BREAKOUT ROOM PACKAGES

BASIC PRESENTATION

PACKAGE \$650

Single room package available in:
Anoka, Isanti, Owatonna, Chaska, Winona,
Little Crow, Wabasha, Shakopee, Mahkato

- 7K Lumen HD Projector
- 16:10 HD Drop Down Screen
- Computer Connections
- Computer Audio Interface
- Podium Audio Connection/One Wired Microphone
- 1 Hour Of AV Assistance

SHAKOPEE BOARDROOM PACKAGE

PACKAGE \$500

- 80" HD Video Display
- Computer Connections
- Computer Audio Interface
- 1 Hour Of AV Assistance

ADVANCED PRESENTATION

PACKAGE \$750

Single room package available in:
Anoka, Isanti, Owatonna, Chaska, Winona

- 7K Lumen HD Projector
- 16:10 HD Drop Down Screen
- Computer Connections
- Computer Audio Interface
- Podium Audio Connection/One Wired Microphone
- One Wireless Microphone (Lavalier/Handheld/Headset)
- 1 Hour Of AV Assistance

OUTSIDE PRODUCTION

Breakout Room Charge \$250/room per day

STREAMING PLATFORMS

We have the capability to send source video and audio to many streaming platforms, and can stream to multiple platforms simultaneously.

SUPPORTED PLATFORMS

- BoxCast
- Cloud Media Group
- DaCast
- Facebook
- IBM Cloud
- Livestream (Vimeo)
- Meridix
- Ministerio TV
- Twitter/X
- Restream
- ScaleEngine
- Smashcast
- StreamingChurch.tv
- StreamShark.io
- StreamSpot
- TiKiLive
- Twitch
- Vimeo
- Wowza Streaming Cloud
- YouTube Live
- Custom RTMP Server

If you do not have a preferred platform, we will use our house Vimeo account and provide links for distribution. Vimeo allows several methods of stream access: public, private link and password. Vimeo also offers the ability to include the following:

- Live Chat During Stream (\$50 add-on)
- User Polls (\$50 add-on)
- Embed Code (free upon request)
- Analytics Dashboard & Reports
- Archive & Download of Completed Events

We are able to host up to three concurrent streams via Vimeo. We may be able to add up to three additional concurrent streams based on availability. Additional streams must be confirmed and reserved in advance.

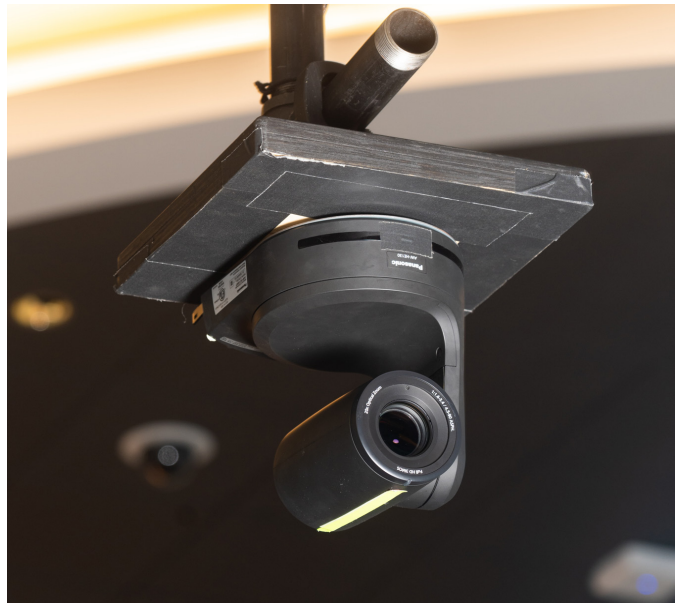

STREAMING PACKAGE 1 | \$3,150 PER DAY

Combines in-room content with live video switching for a single live-stream to a single platform.

- Single concurrent stream up to 1080p 6Mbps (29.97 or 59.94). Single delivery platform.
- Stream will be a combination of the event program(s) and specialized content or switching for the online audience.
- Includes broadcast-quality camera, video switcher, streaming laptop, streaming encoder and hardline internet access necessary for streaming.
- Up to eight hours of content streaming (per day). Additional hours may be added to the day at the rate of \$100 per hour.
- Video and audio will stream directly to your preferred platform OR we will provide you with a Vimeo streaming link to share with your remote audience.

PREREQUISITES

Audio/Video package

STREAMING PACKAGE 2 | \$3,990 PER DAY

Includes everything in Package 1 plus incorporates the ability to add an online meeting (via Zoom or similar) into the stream.

- Single concurrent stream/program up to 1080P 6Mbps (29.97 or 59.94). Single delivery platform.
- Stream will be a combination of the event program, provided content and/or switching for the online audience as well as integration of the online meeting.
- Includes broadcast-quality camera, video switcher, streaming laptop, streaming encoder, virtual meeting laptop, USB audio interface, USB HDMI video capture device and hardline internet access necessary for streaming.
- Up to eight hours of content streaming (per day). Additional hours may be added to the day at the rate of \$150 per hour.
- Video and audio will stream directly to your preferred platform OR we will provide you with a Vimeo streaming link to share with your remote audience.

PREREQUISITES

Audio/Video package

STREAMING ADD-ON OPTIONS

ADDITIONAL DELIVERY PLATFORMS

\$100 setup fee per each additional platform (resources: 1 person 2 hours for set up, testing and monitoring)

ADDITIONAL STREAM TIME (BEYOND 8 HOURS PER DAY)

Package 1 - \$100 per hour

Package 2 - \$150 per hour (additional labor time in addition to this as utilized)

RECORDING PROGRAM STREAM (EACH)

\$120 per unit (unit = up to eight hours within one event day) delivered via Dropbox download link

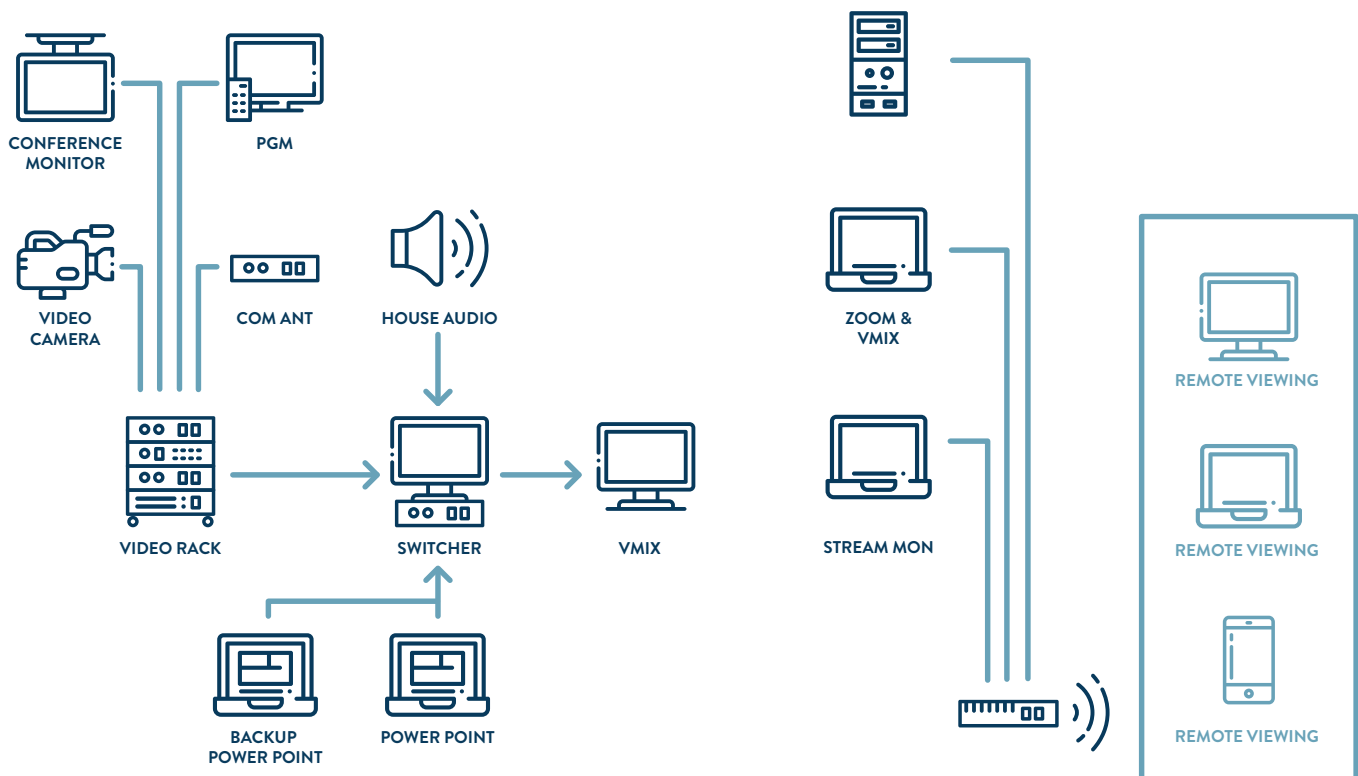

LABOR RATE

AV technical assistance starts at \$75/hour with a minimum of 4 hours. Additional labor charges based on extent of setup. 72-hour notice required for all labor.

AV Tech (minimum 4 hours)	\$75/hr
Load In/Out Liaison	\$100/hr
AV Tech Assistance After Hours	\$100/hr
AV Tech Assistance Overtime	\$140/hr
Stagehand	\$500/8 hrs
Audio Engineer	\$600/8 hrs
Lighting Designer	\$600/8 hrs
Spot Operator	\$500/8 hrs
Camera Operator	\$500/8 hrs
AV Supervisor	\$325/8 hrs
Show Call Spot Fee	\$75
Show Call Camera Fee	\$75



INTERNET SERVICES

Complimentary internet access is available property-wide for email and web browsing. Best utilized for groups of 40 or less or for playing short web-based videos.

WI-MEET PACKAGE

Designed for web-based presentations, product demonstrations and trainings. The Wi-Meet package is ideal for meetings or events with 40 – 80 guests and includes:

- 3 Mbps of dedicated bandwidth for presenter(s)
- 10 Mbps of dedicated bandwidth for attendees
- On-site IT staff to monitor and manage Wi-Fi network

\$640/DAY

WI-COMMUNICATE PACKAGE

Designed for conferences or event with multiple breakout rooms, high-definition presentations and live social media feeds. The Wi-Communicate package is ideal for meetings or events with 80 – 120 guests and includes:

- 6 Mbps of dedicated bandwidth for presenter(s)
- 40 Mbps of dedicated bandwidth for attendees
- On-site IT staff to monitor and manage Wi-Fi network

\$1,350/DAY

WI-HYBRID PACKAGE

Designed for conferences with multiple breakout rooms, remote attendees, virtual offices and fully integrated hybrid meetings. The Wi-Hybrid package is ideal for large conferences or events with live streaming and connecting to remote locations and includes:

- 100 Mbps of dedicated bandwidth to conduct hybrid meetings
- Dedicated bandwidth for breakout room presenter(s) with wired connections available
- On-site IT staff to monitor and manage Wi-Fi network
- One wired connection with 6 Mbps of dedicated bandwidth per breakout room

\$2,950/DAY

Hardwire Connection	\$300/day
Credit Card Network Connection	\$65/day
Add Hard Line to any Wi-Fi package	\$130/day
Additional Bandwidth	\$10 per MB/day

PHONE SERVICE

Local/800 Phone Service with Handset and Dedicated Phone	\$50
Business Speakerphone with Long Distance and Dedicated Phone	\$100



POWER

Trade Show Booth 120VAC 20A (preorder)	\$50
Trade Show Booth 208VAC 3P 200A (preorder)	\$370
Trade Show Booth 208VAC 3P 200A (day of)	\$470
Trade Show Booth 240 VAC 50A (preorder)	\$150
Trade Show Booth 240 VAC 50A (day of)	\$250
400 AMP 3 Phase with Distro	\$470
Extension Cord with Quad Box	\$50/ea



2400 Mystic Lake Blvd.
Prior Lake, MN, 55372



mysticlakecenter.com



sales@mysticlake.com
1-866-832-6402

OWNED & OPERATED BY THE SHAKOPEE
MDEWAKANTON SIOUX COMMUNITY

Mystic Lake®, Mystic Lake Casino Hotel®, Mystic Lake Center®, Little Six Casino®, Little Six® Club M® and Mystic Showroom® are registered trademarks of the Shakopee Mdewakanton Sioux Community.



MYSTIC LAKE
CENTER